



**AFI Branding | ReFrame® Profile Guide 1.4**

# contents

<u>SS101 single sided ReFrame®</u>	<u>03</u>
<u>SS103 single sided ReFrame®</u>	<u>05</u>
<u>SS105A single sided niche ReFrame®</u>	<u>08</u>
<u>M1614</u>	<u>08</u>
<u>SS106A single sided ReFrame®</u>	<u>09</u>
<u>SS108 single sided ReFrame®</u>	<u>10</u>
<u>SS201 single sided timber ReFrame®</u>	<u>11</u>
<u>DS101 double sided ReFrame®</u>	<u>12</u>
<u>DS102 double sided ReFrame®</u>	<u>13</u>
<u>DS103 double sided ReFrame®</u>	<u>15</u>
<u>DS105 double sided cube ReFrame® - locking magnetic</u>	<u>17</u>
<u>ILS50 single sided backlit led illuminated ReFrame®</u>	<u>18</u>
<u>ILS80 single sided edge lit illuminated ReFrame®</u>	<u>19</u>
<u>ILS120 single sided edge lit illuminated ReFrame®</u>	<u>20</u>

<u>ILS140 double sided edge lit illuminated ReFrame®</u>	<u>22</u>
<u>KT001 ktrak</u>	<u>23</u>
<u>KT002 ktrak piccolo</u>	<u>24</u>
<u>RC040 cube ReFrame®</u>	<u>25</u>
<u>RC051 cube ReFrame® - locking</u>	<u>27</u>
<u>RC060 cube ReFrame® - locking</u>	<u>28</u>

# SS101 single sided ReFrame®

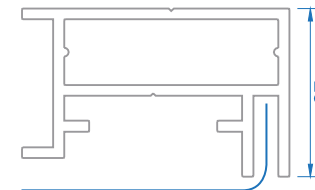

## applications

- Can be wall mounted or suspended
- Ideal profile for curving/bending

## components

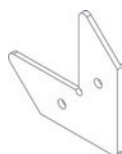

**CORNER BRACKET**  
CB003 (PACK OF 4)  
INC GRUB SCREWS



**JOINER**  
JNR004 (PACK OF 2)  
INC GRUB SCREWS



**SHS BRACE 20X20**  
BR002

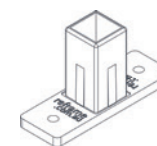

**BRACE LUG**  
BR022  
INC X2 SDS

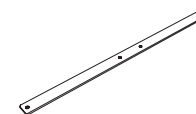

**STIFFENER**  
JNR003 (PACK OF 2)  
INC SCREWS

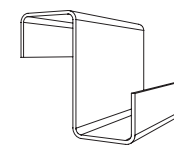

**HANGING BRACKET**  
HBSS108

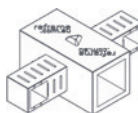

**BRACE MID-RAIL**  
BR023

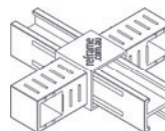

**BRACE 4-WAY**  
BR024

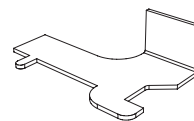

**MB BRACKET**  
MBSET (PACK OF 4)  
INC SCREWS

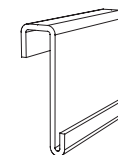

**GAZ BRACKET**  
HBGM

## accessories



**POS SADDLE**  
RP004



**RIGGING POINT**  
RP008 (M8 RATED)



**RIGGING POINT**  
RP006 (M6 STAINLESS)



**WALL MOUNTING BRACKET** INC SCREWS  
WMB001 (PACK OF 2)



**EXHIBIT FIXING KIT**  
FKEXH (PACK OF 2)

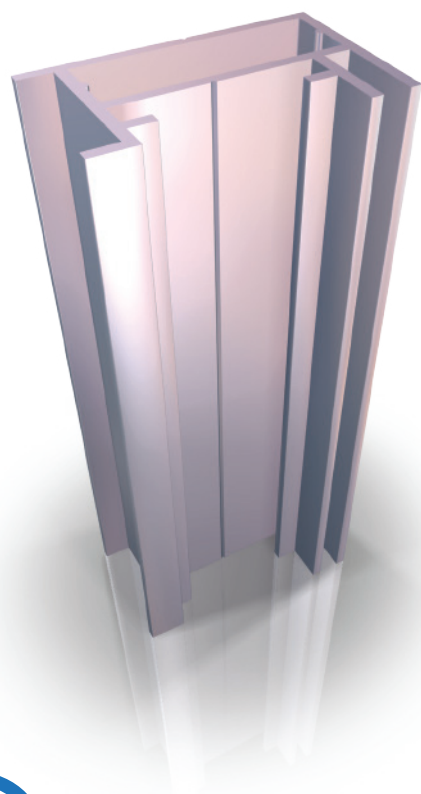

# SS101 single sided ReFrame®

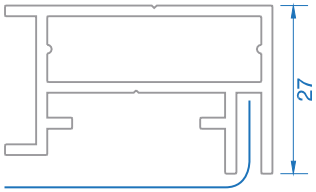

## 40mm Octanorm®

BEAM BRACKET SECURES SS101 REFRAME® TO OCTANORM RAIL WHEN A POST IS NOT AVAILABLE

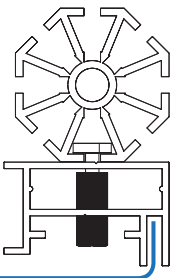

CORNER BRACKET SECURES SS101 REFRAME® TOGETHER

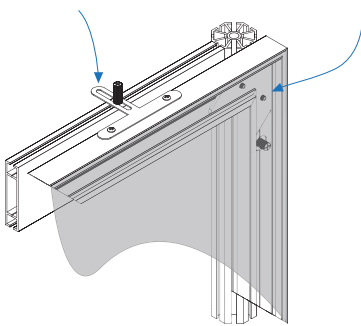

## 40mm maxima

BEAM BRACKET SECURES SS101 REFRAME® TO OCTANORM RAIL WHEN A POST IS NOT AVAILABLE

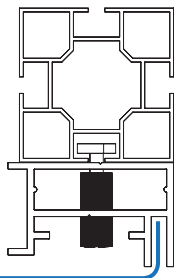

CORNER BRACKET SECURES SS101 REFRAME® TOGETHER

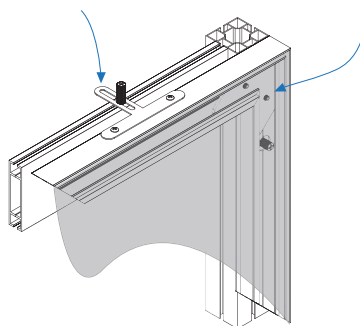

## 80mm maxima

NOTE. SS103 REFRAME® IS RECOMMENDED FOR THIS APPLICATION

EXHIBIT FIT KIT SECURES SS101 REFRAME® TO MAXIMA BEAM

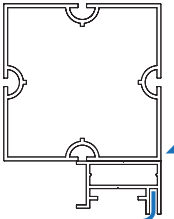

CORNER BRACKET SECURES SS101 REFRAME® TOGETHER

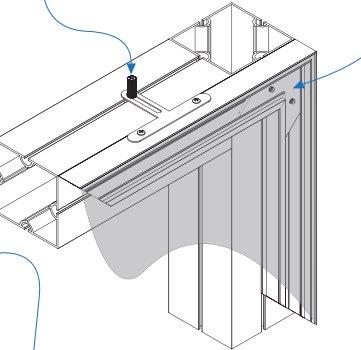

SLOT SCREW FIXING CANNOT BE USED IF HIDING THE MAXIMA FRAME IS REQUIRED

## hints & recommendations

### internal corners

- Size ReFrame® to meet flush in corner
- Thickness of ReFrame® must be accounted for when sizing

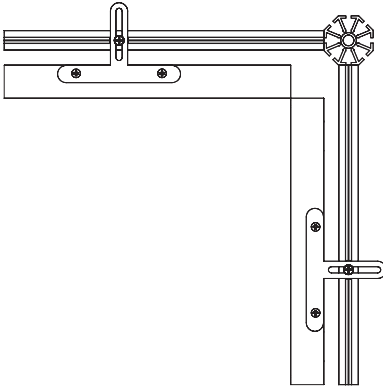



# SS103 single sided ReFrame®

replacing SS102

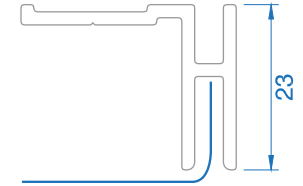

## applications

- Can be fixed to Octanorm® or Maxima
- Can be secured to a wall
- Replacing SS102

## components

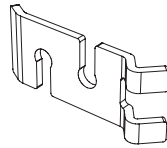

**EXHIBITION FIXING  
CLAMP**  
JNREXB

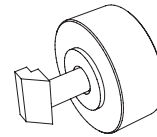

**KNURLED NUT**  
KN001

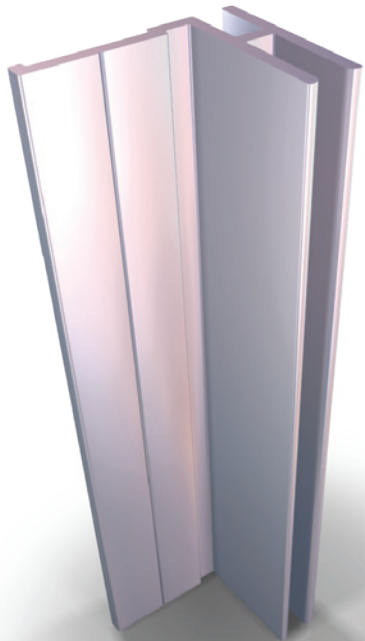

# SS103 single sided ReFrame®

replacing SS102

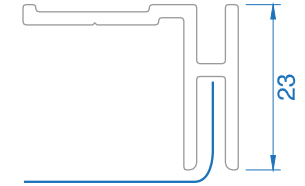

## 40mm maxima

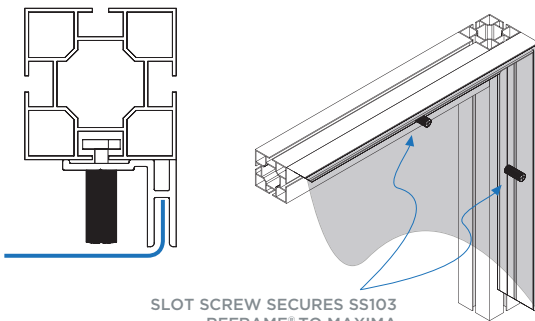

## 80mm maxima

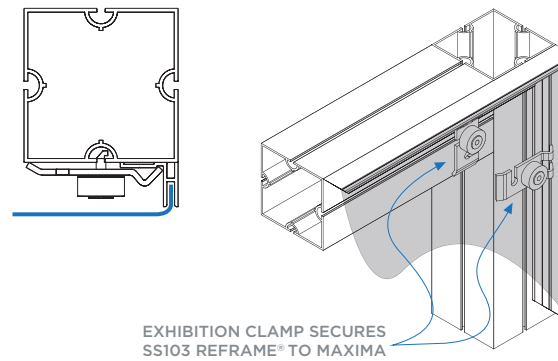

## 120mm maxima

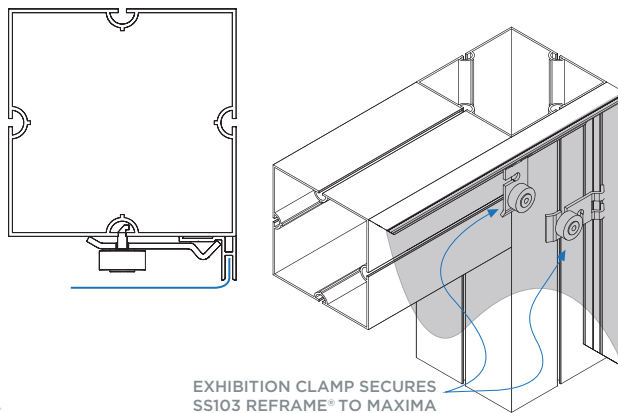

## hints & recommendations

### fixing methods

- The bracket secures the SS103 ReFrame® flush with the outer edge of the Maxima
- The entire face of the Maxima can be covered using this ReFrame®

### FIXING FOR 40MM OCTANORM® & MAXIMA

SLOT SCREW SECURES SS103 REFRAME® TO OCTANORM POST

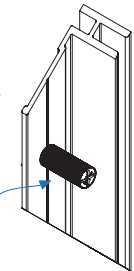

### FIXING FOR 80MM MAXIMA

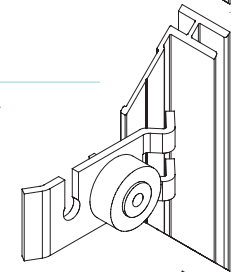

### FIXING FOR 120MM MAXIMA

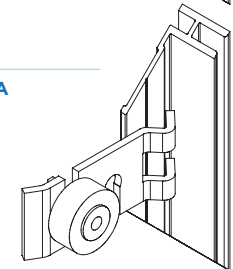

# SS103 single sided ReFrame®

replacing SS102

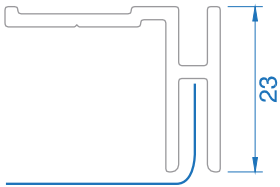

## hints & recommendations

seamless cladding around corners

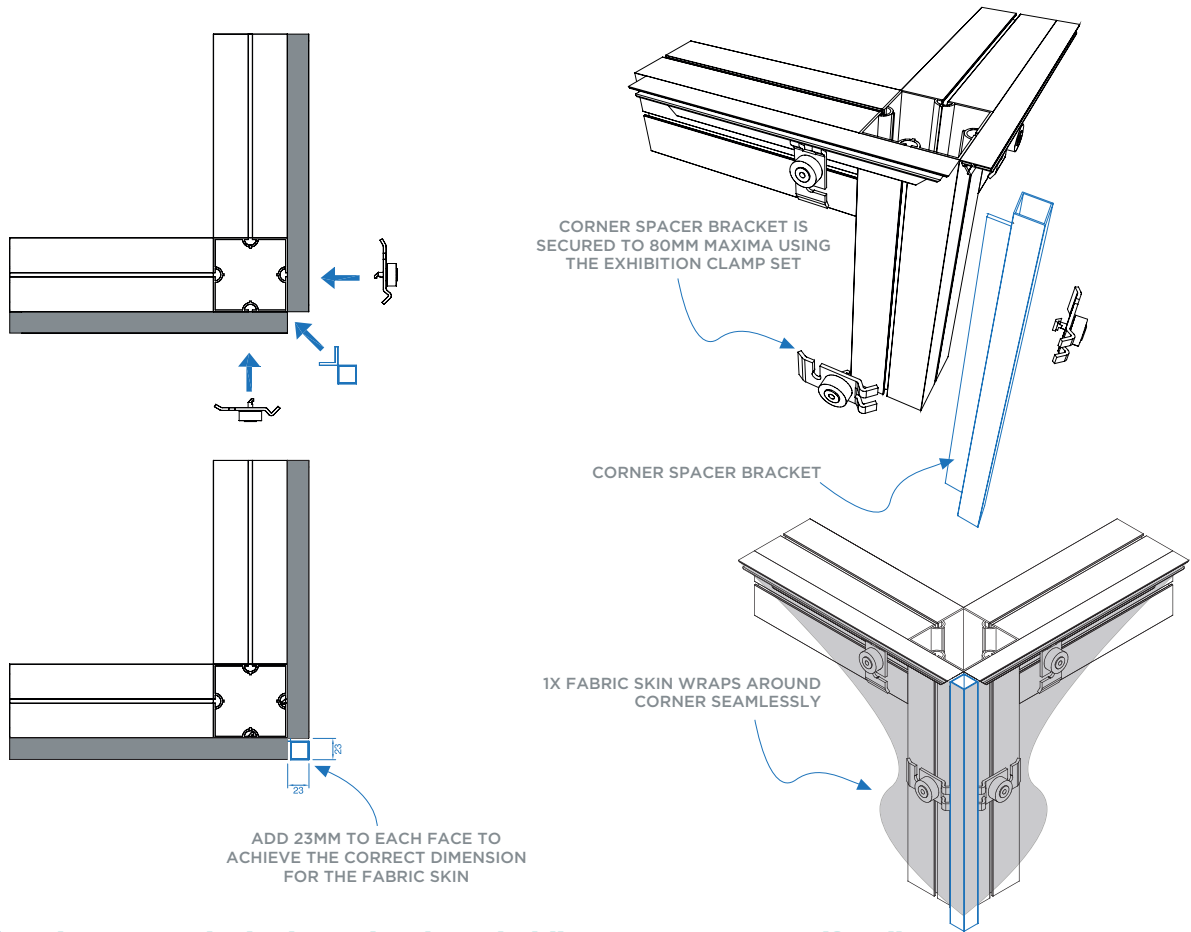

**Hint.** the same principals apply when cladding onto custom mdf walls

## hints & recommendations

SS103 corner spacer bracket

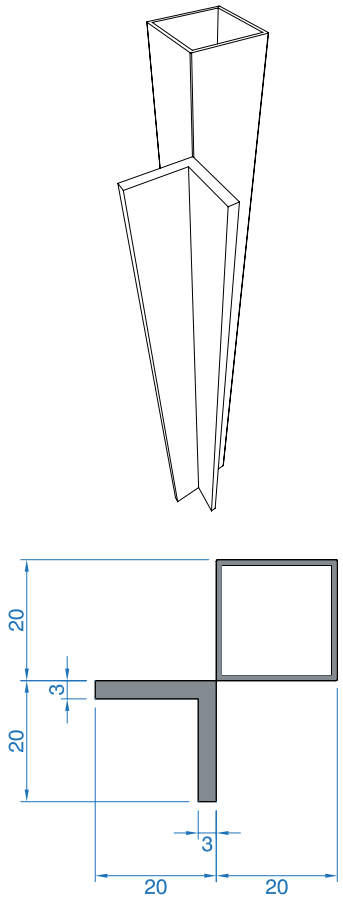

# SS105A single sided niche ReFrame®

## applications

- Permanent mounting into a cavity
- Ideal to retro-fit existing lightbox

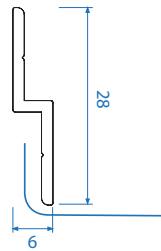

# M1614

## applications

- Permanent mounting into a cavity
- Ideal to retro-fit existing lightbox

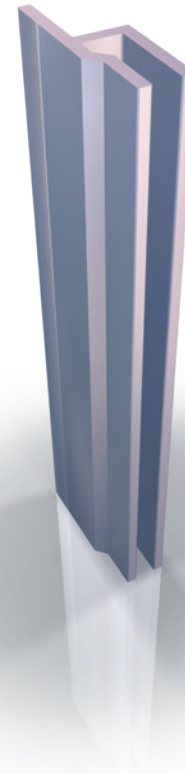
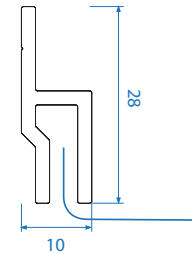

# SS106A **single sided ReFrame®**

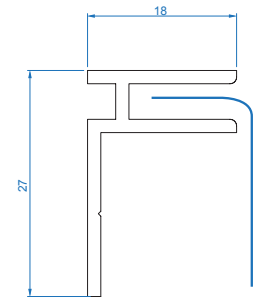

## applications

- Low cost frame for permanent installation
- Must be secured into position

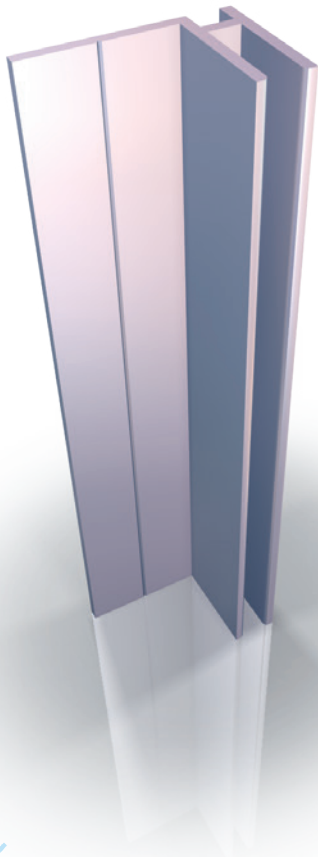

# SS108 single sided ReFrame®

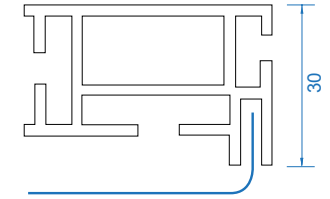

## applications

- Large free standing ReFrames®
- Ideal for sectional ReFrames®

## components

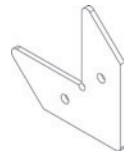

**CORNER BRACKET**  
CB003 (PACK OF 4)  
INC GRUB SCREWS

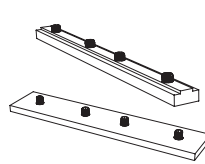

**JOINER**  
JNRSTA & JNRSTB  
INC GRUB SCREWS

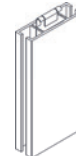

**TWIST LOCK BRACING**  
BR001

## accessories



**POS SADDLE**  
RP004



**RIGGING POINT**  
RP008 (M8 RATED)



**SMALL SIDE MOUNT FOOT**  
FT01L HALF LEFT



**SMALL SIDE MOUNT FOOT**  
FT01R HALF RIGHT



**SMALL SIDE MOUNT FOOT**  
FT001



**SMALL FLAT FOOT**  
FL001

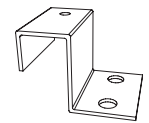

**FLAT FOOT CONNECTOR**  
FFC



**ARM LIGHT**  
HAL001

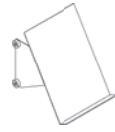

**ANGLED BROCHURE HOLDER**  
BHL001 LEFT



**ANGLED BROCHURE HOLDER**  
BHR001 RIGHT

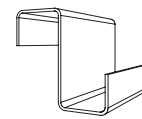

**HANGING BRACKET**  
HBSS108

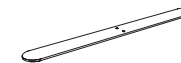

**LARGE FLAT FOOT**  
FL002

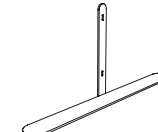

**LARGE SIDE MOUNT FOOT**  
FT002



**EXHIBIT FIXING KIT**  
FKEXH (PACK OF 2)

# SS201 single sided timber ReFrame®

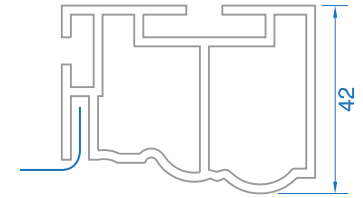

## applications

- Wall mounted
- Illuminated option
- Choice of 6 timber finishes
- Maximum length of 6m

## components



**CORNER BRACKET**  
CB007 (PACK OF 4)

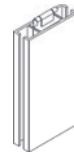

**TWIST LOCK BRACING**  
BR001

## accessories



**ILLUMINATION**  
P.O.A

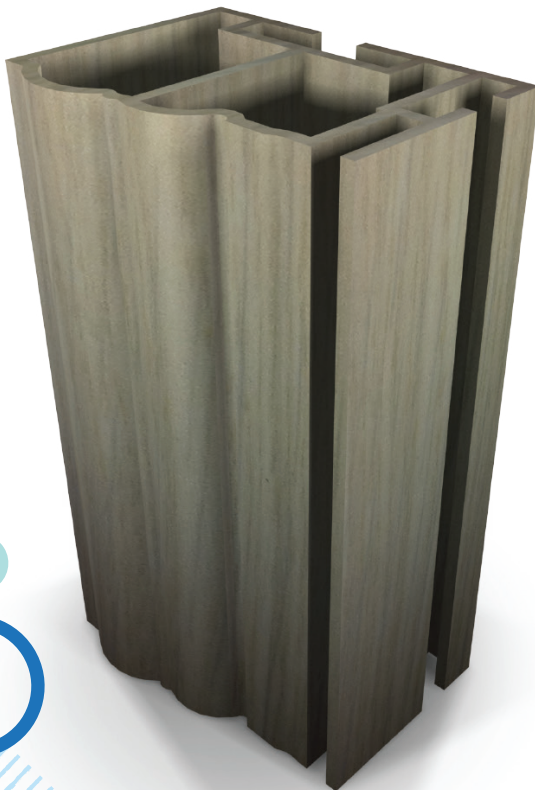

**DARK NATURAL**



**WALNUT**



**RUSTIC NATURAL**



**SANDALWOOD**



**WHITEWASH**



**HAMPTONS**

# DS101 double sided ReFrame®

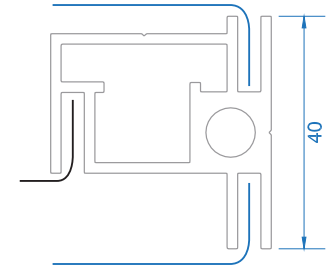

## applications

- Double-sided curved ReFrames
- Free standing or suspended
- Ability to add an internal blockout liner
- Used for rolling

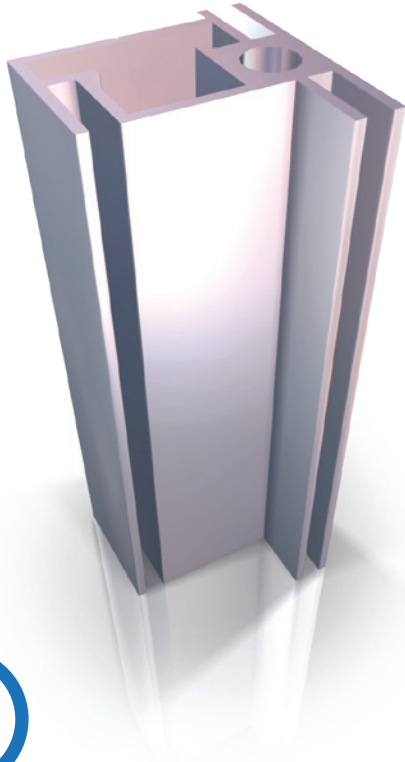

## components

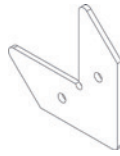

**CORNER BRACKET**  
CB003 (PACK OF 4)  
INC M6 X8 BUTTON  
HEAD SCREWS



**JOINER**  
JNR004 (PACK OF 2)  
INC M6 X8 BUTTON  
HEAD SCREWS



**SHS BRACE 20X20**  
BR002

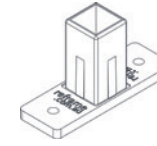

**BRACE LUG**  
BR022  
INC X2 SDS

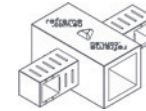

**BRACE MID-RAIL**  
BR023

## accessories

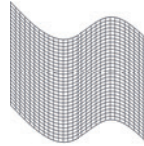

**INTERNAL  
BLOCKOUT LINER**



**RIGGING POINT**  
RPO08 (M8 RATED)



# DS102 double sided ReFrame®

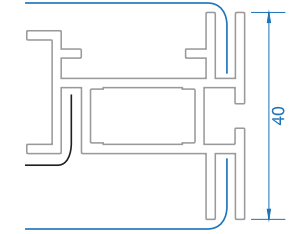

## applications

- Free standing or suspended
- Ability to add an internal blockout liner
- Cannot be used for curved applications

## components

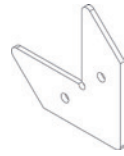

**CORNER BRACKET**  
CB003 (PACK OF 4)  
INC GRUB SCREWS



**JOINER**  
JNR004 (PACK OF 2)  
INC GRUB SCREWS



**SHS BRACE 20X20**  
BR002

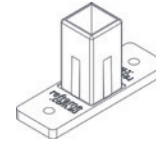

**BRACE LUG**  
BR022  
INC X2 SDS

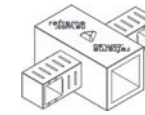

**BRACE MID-RAIL**  
BR023

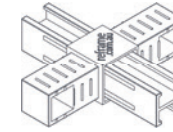

**BRACE 4-WAY**  
BR024

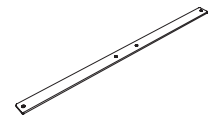

**STIFFENER**  
JNR003 (PACK OF 2)  
INC SCREWS

## accessories



**POS SADDLE**  
RP004



**RIGGING POINT**  
RP008 (M8 RATED)



**RIGGING POINT**  
RP006 (M6 STAINLESS)



**SMALL SIDE MOUNT FOOT**  
FT01L HALF LEFT



**SMALL SIDE MOUNT FOOT**  
FT01R HALF RIGHT



**SMALL SIDE MOUNT FOOT**  
FT001



**SMALL FLAT FOOT**  
FL001

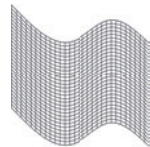

**INTERNAL BLOCKOUT LINER**

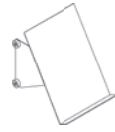

**ANGLED BROCHURE HOLDER**  
BHL001 LEFT



**ANGLED BROCHURE HOLDER**  
BHR001 RIGHT



**ARM LIGHT**  
HAL001

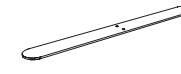

**LARGE FLAT FOOT**  
FL002

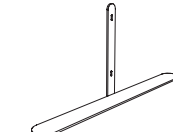

**LARGE SIDE MOUNT FOOT**  
FT002

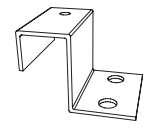

**FLAT FOOT CONNECTOR**  
FFC

# DS102 double sided ReFrame®

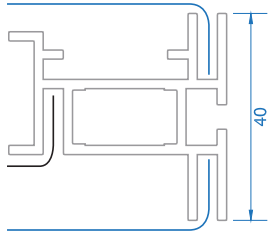

## applications

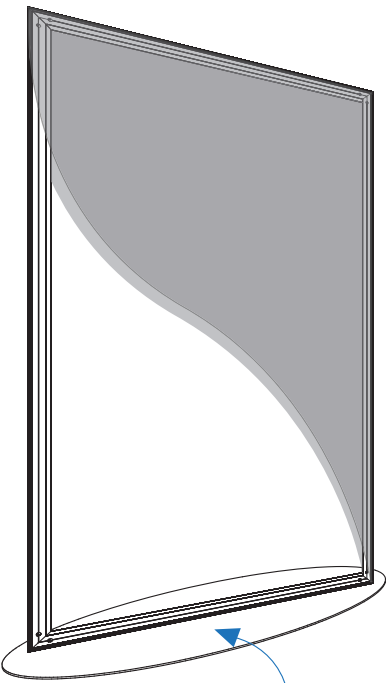

CUSTOM ELLIPTICAL BASE PLATE

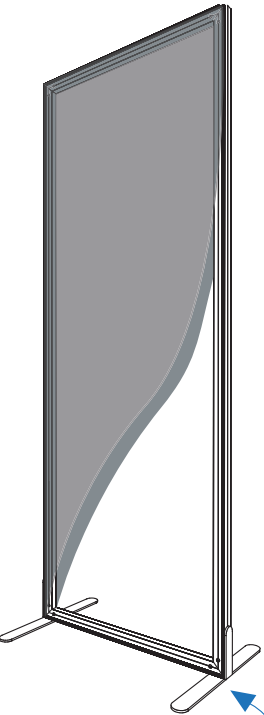

SIDE MOUNTED FLAT FOOT

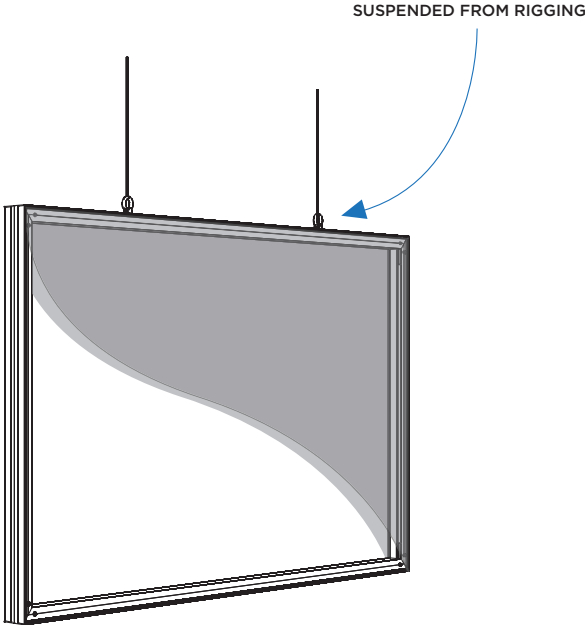

SUSPENDED FROM RIGGING

# DS103 double sided ReFrame®

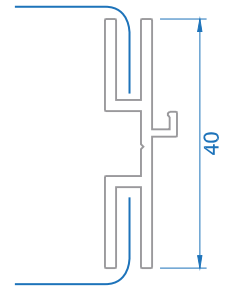

## applications

- Designed to suit Octanorm® & Maxima
- Ideal for curving and bending
- Can be utilised for custom fabricated solutions, including light boxes
- Self tapper screw does not damage the Octanorm® or Maxima

## components



**SELF TAPPING  
SCREW**  
STS001

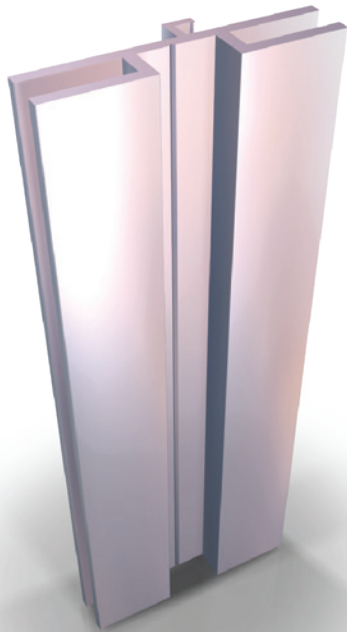

# DS103 double sided ReFrame®

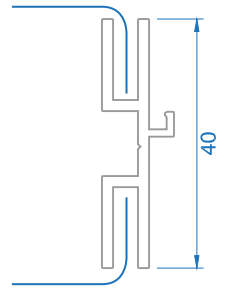

## 40mm Octanorm®

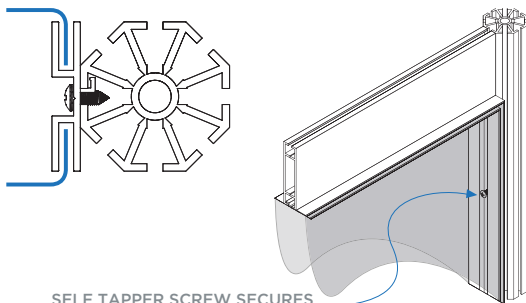

SELF TAPPER SCREW SECURES  
DS103 REFRAME® TO POST

## 40mm maxima

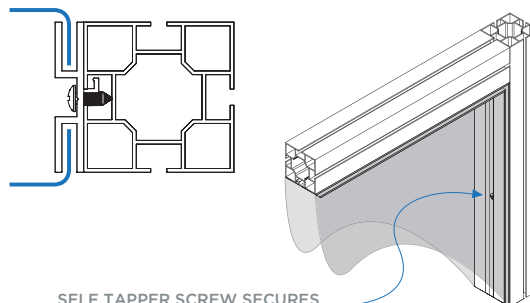

SELF TAPPER SCREW SECURES  
DS103 REFRAME® TO POST

## 80mm maxima

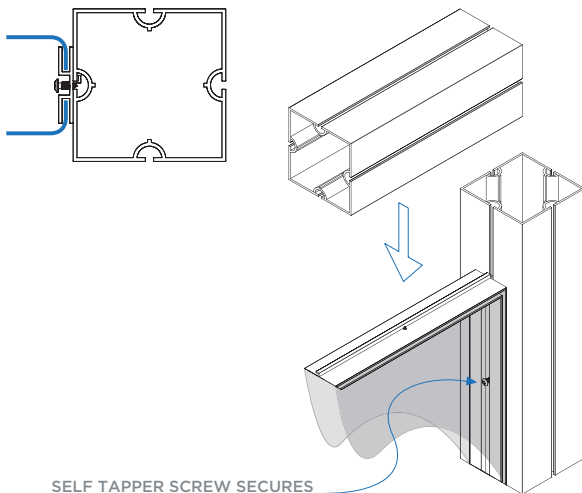

SELF TAPPER SCREW SECURES  
DS103 REFRAME® TO POST

## 120mm maxima

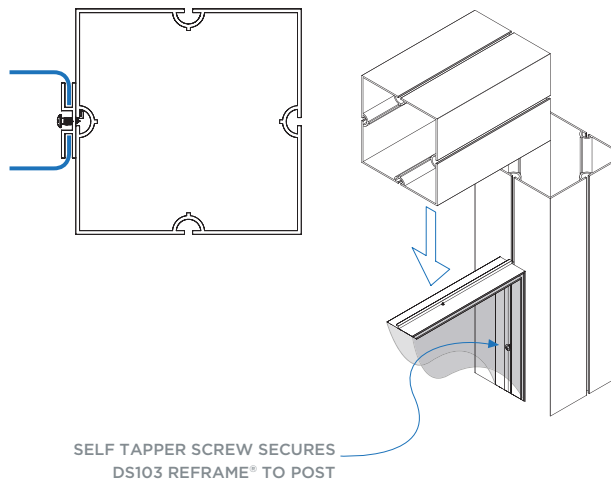

SELF TAPPER SCREW SECURES  
DS103 REFRAME® TO POST

## hints & recommendations

### mdf/custom solutions

- Reverse mitred to avoid removing rear leg
- Creates a shadowless light box front to custom made solutions
- Simply screws into substrate

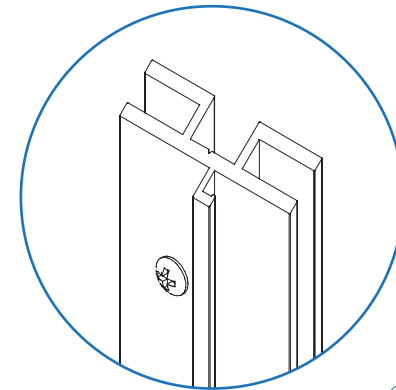

REVERSE MITRED DS103

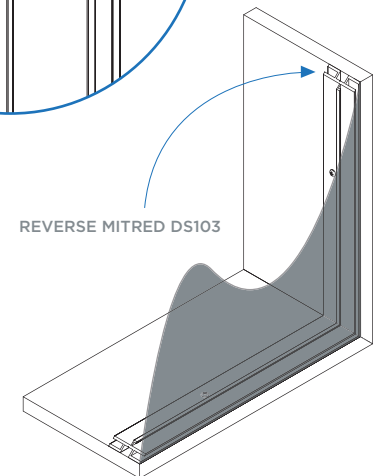

# DS105 double sided ReFrame® - locking magnetic

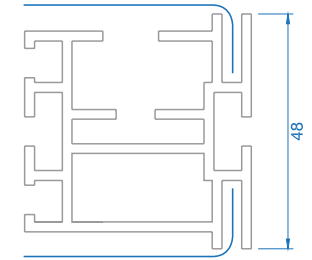

## applications

- Free standing or wall mounted magnetic ReFrame®

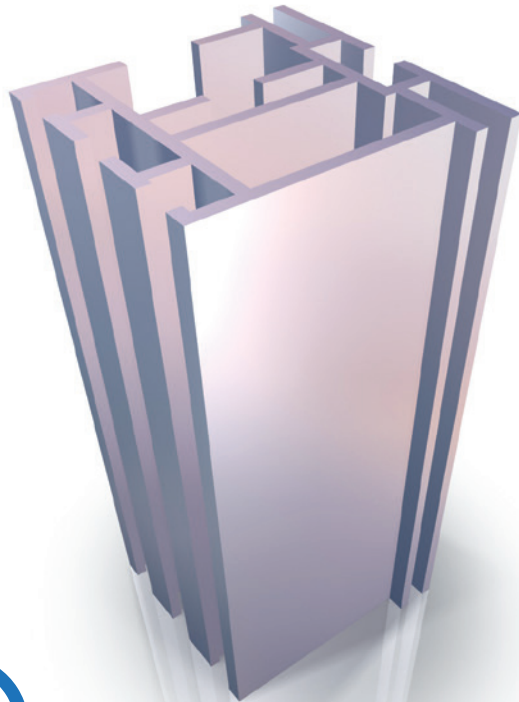

## components



**CORNER BRACKET**  
CB007 (PACK OF 4)

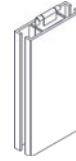

**TWIST LOCK BRACING**  
BR001



**JOINER**  
JNR004 (PACK OF 2)  
INC GRUB SCREWS

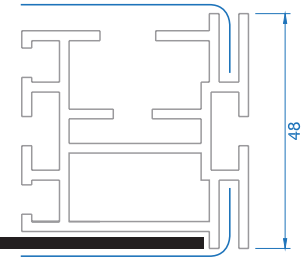

STEEL BACKING PLATE

## accessories



**SMALL SIDE MOUNT FOOT**  
FT01L HALF LEFT



**SMALL SIDE MOUNT FOOT**  
FT01R HALF RIGHT



**SMALL SIDE MOUNT FOOT**  
FT001



**SMALL FLAT FOOT**  
FL001



**BROCHURE HOLDER**  
MF64



**ARM LIGHT**  
HAL001



**MAGNET**  
MF15



**STRAIGHT BRACKET**  
MF306S

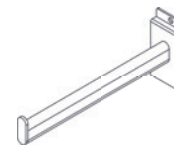

**STRAIGHT ARM**  
MF204S



**SLOPING ARM**  
MF202S

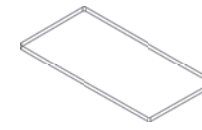

**ACRYLIC SHELF**  
8MM

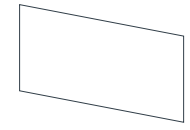

**STEEL BACKING PLATE**

# ILS50 single sided backlit led illuminated ReFrame®

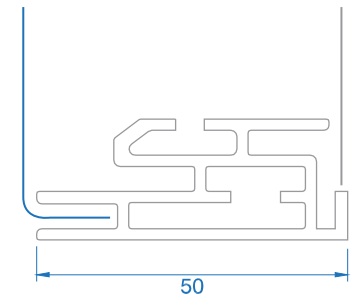

## applications

- Single-sided illuminated lightbox
- Wall mounted

## components

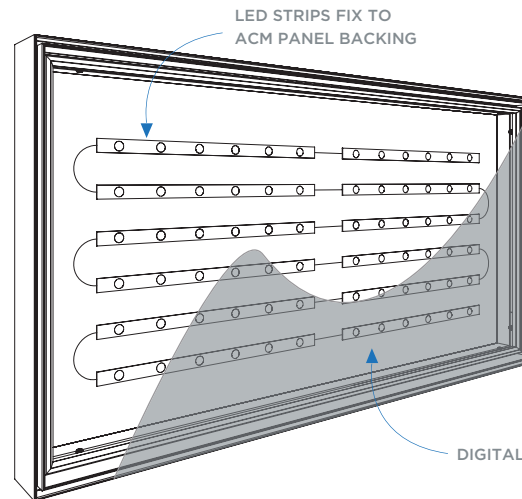
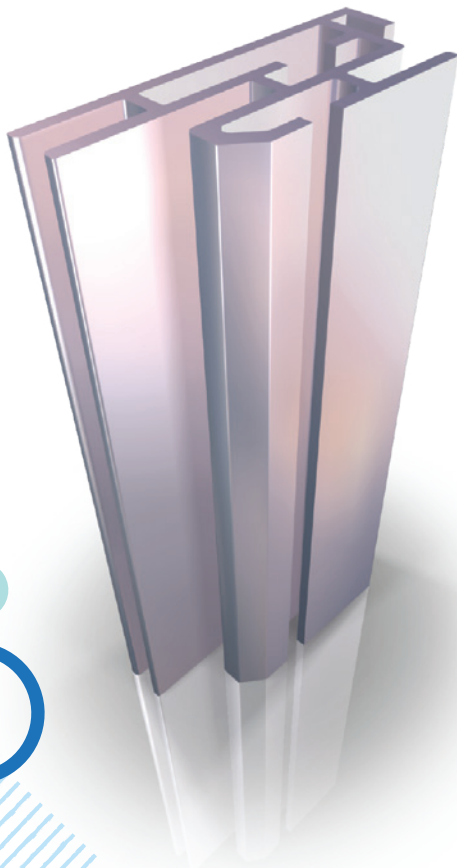

FRONT VIEW

ALUMINIUM COMPOSITE PANEL

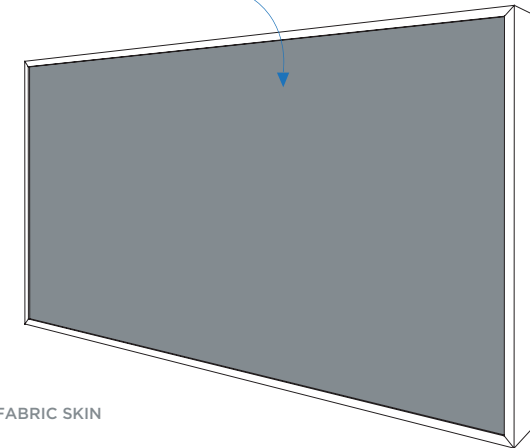

BACK VIEW

# ILS80 single sided edge lit illuminated ReFrame®

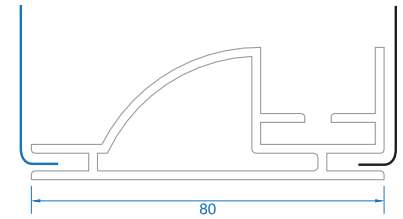

## applications

- Single-sided illuminated lightbox
- Wall mounted
- Maximum recommended dimension in one direction is 2m (due to light dissipation)

## components

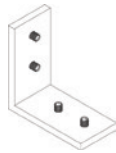

**CORNER BRACKET**  
CB006 (PACK OF 4)

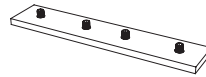

**JOINER**  
JNRSTB (PACK OF 2)



**LIGHT BOX BRACE**  
LBR001

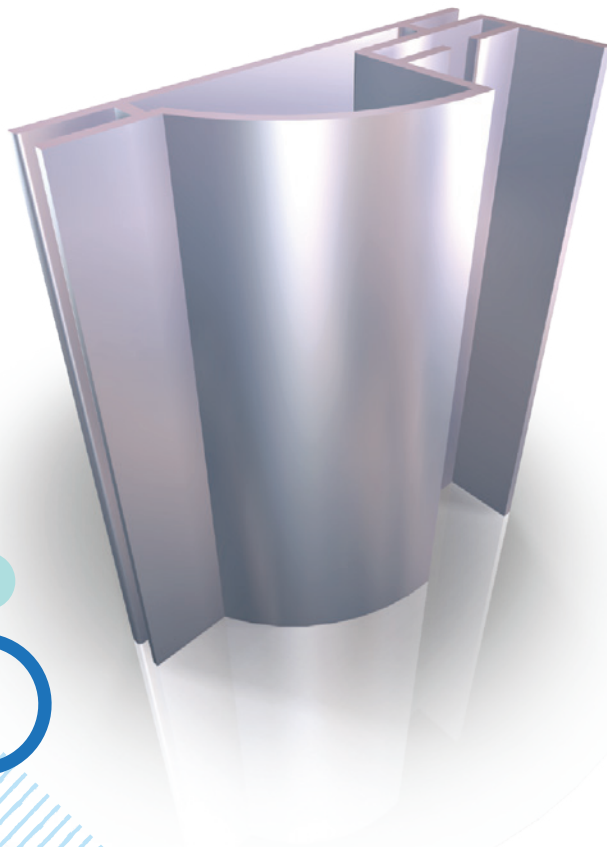

## accessories

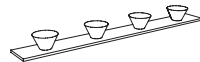

**LED MODULE**  
LED4W, LED8W,  
LED20W



**WALL MOUNTING BRACKET**  
WMB001 (PACK OF 2)

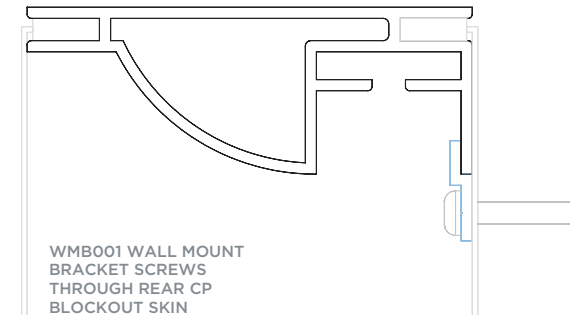



# ILS120 single sided edge lit illuminated ReFrame®

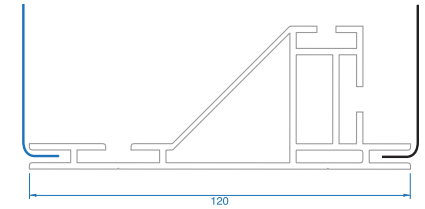

## applications

- Single-sided illuminated lightbox
- Wall mounted or free standing
- Maximum dimension in one direction is 3m (due to 3m fabric width)

## components

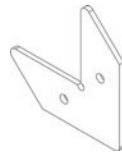

**CORNER BRACKET**  
CB003 (PACK OF 4)

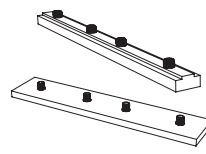

**JOINER**  
JNRSTA & JNRSTB  
INC GRUB SCREWS



**LIGHT BOX BRACE**  
LBR001

## accessories

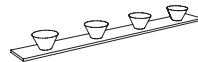

**LED MODULE**  
LED4W, LED8W,  
LED20W

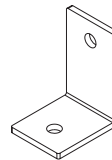

**WALL MOUNTING BRACKET**  
WMB002

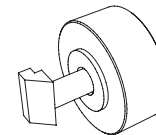

**KNURLED NUT**  
KN001

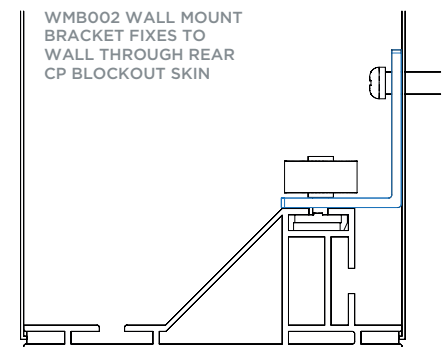



# ILS120 single sided edge lit illuminated ReFrame®

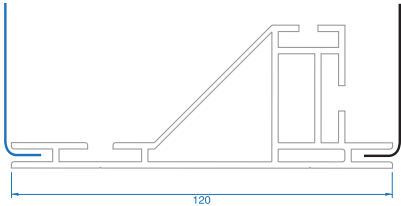

## applications

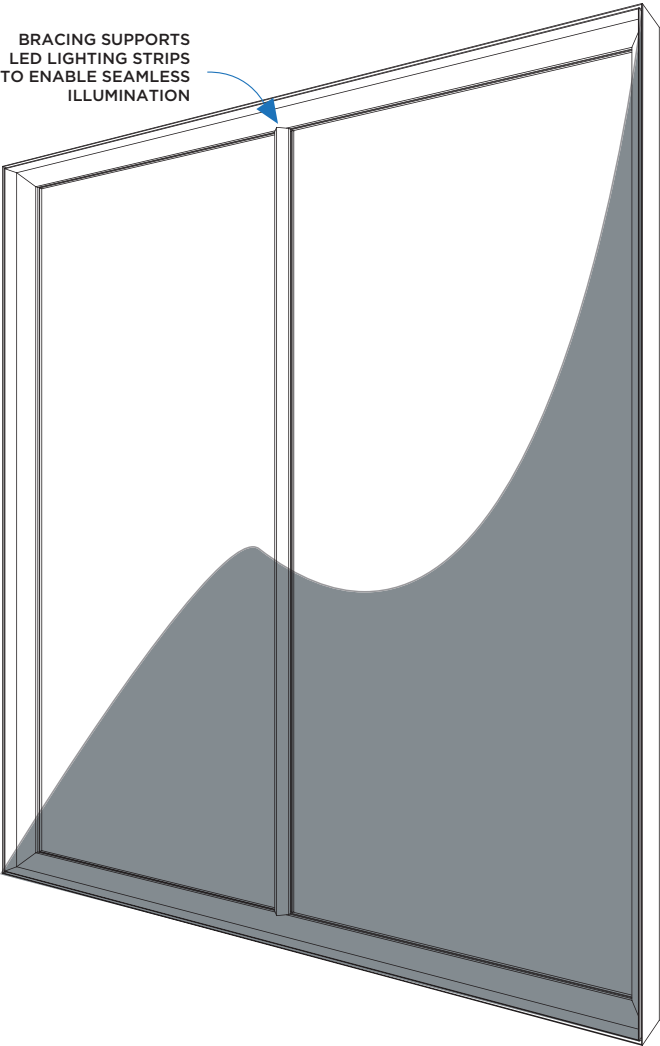

# ILS140 double sided edge lit illuminated ReFrame®

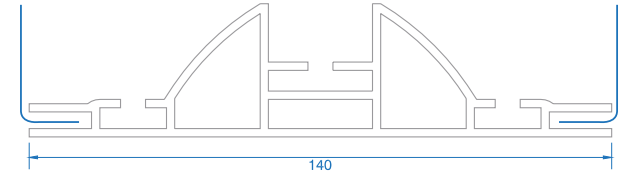

## applications

- Double-sided illuminated lightbox
- Free standing or suspended
- Maximum dimension in one direction is 3m (due to 3m fabric width)
- Can be curved

## components

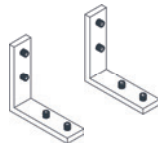

**CORNER BRACKET**  
CB009 (PACK OF 8)  
INC GRUB SCREWS



**JOINER**  
JNR140 (PACK OF 2)  
INC GRUB SCREWS



**LIGHT BOX BRACE**  
LBR001

## accessories



**LARGE FLAT FOOT**  
FL003

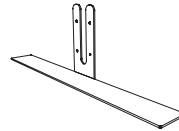

**LARGE SIDE MOUNT FOOT**  
FT003



**SMALL SIDE MOUNT FOOT**  
FT001



**SMALL FLAT FOOT**  
FL001



**RIGGING POINT**  
RP008 (M8 RATED)

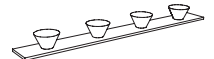

**LED MODULE**  
LED4W, LED8W,  
LED20W



# KT001 ktrak

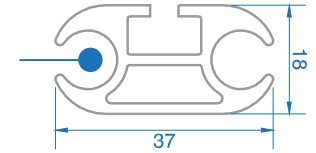

## applications

- Single sided suspended banners
- Can be curved

## components

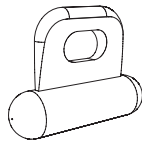

**PLASTIC HANGING POINT**  
RPSL



**END CAP**  
EC001



**JOINER**  
JNR008



**ANGELS**  
WIREHANGER 2M  
INC 2MM WIRE, LOOP  
1 END, 2M LONG WITH  
ANGEL END PIECE

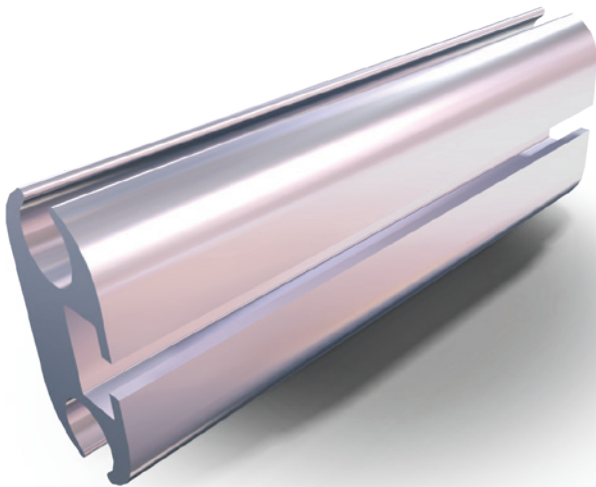

## assembly

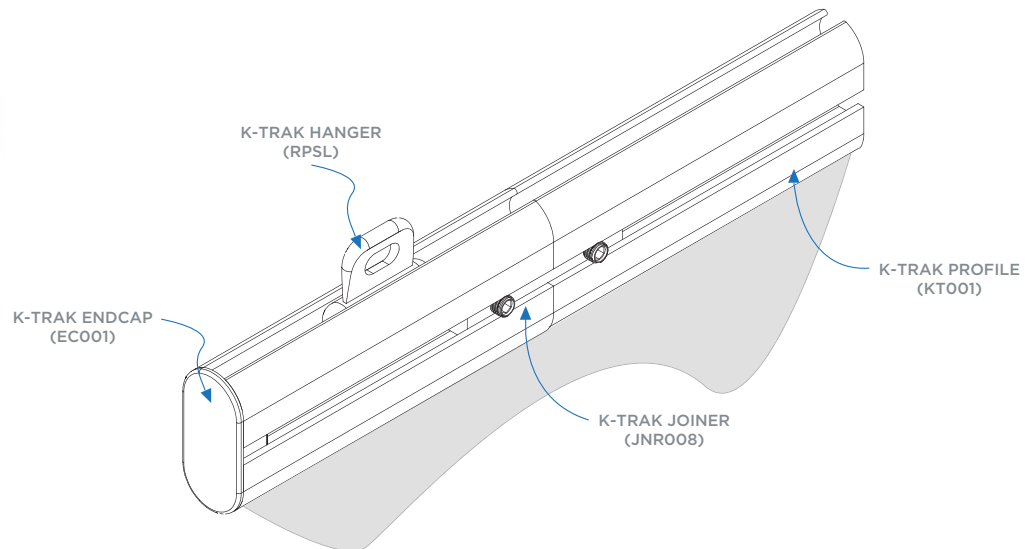

# KT002 **ktrak piccolo**

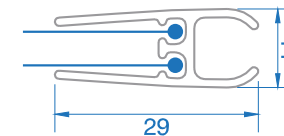

## applications

- Light weight single or double sided suspended banners
- Maximum Length 3m
- Cannot be curved or joined

## components

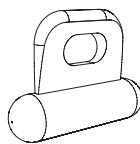

**PLASTIC HANGING POINT**  
RPSL



**END CAP**  
EC002



**ANGELS**  
WIREHANGER 2M  
INC 2MM WIRE, LOOP  
1 END, 2M LONG WITH  
ANGEL END PIECE

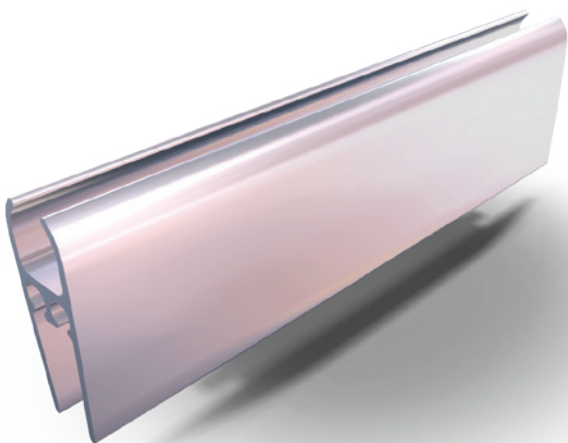

## components

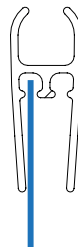
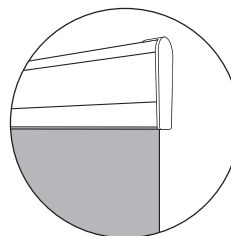
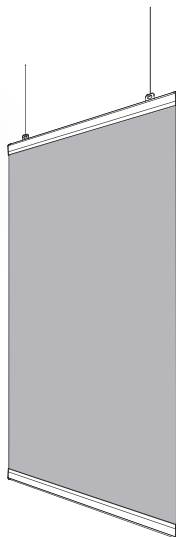

SINGLE FABRIC SKIN

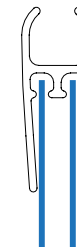
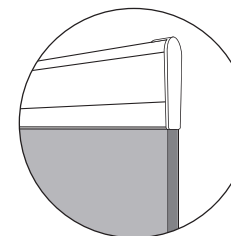

DOUBLE FABRIC SKIN

# RC040 cube ReFrame®

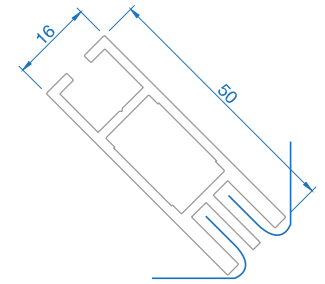

## applications

- Free standing or suspended
- Shadowless illumination
- Maximum size is 4x4x4m

## components

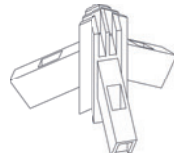

**CORNER BRACKET**  
CB040 (PACK OF 8)



**SHS BRACE 20X20**  
BR002

## accessories



**RIGGING POINT**  
RP008 (M8 RATED)



**ILLUMINATION**  
P.O.A

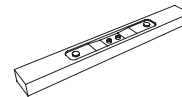

**JOINER**  
Z977



**BEAM ADAPTOR**  
M1545



**RIGGING POINT**  
RP006 (M6 STAINLESS)



**BEAM ADAPTOR**  
M1547



**BEAM**  
Z460

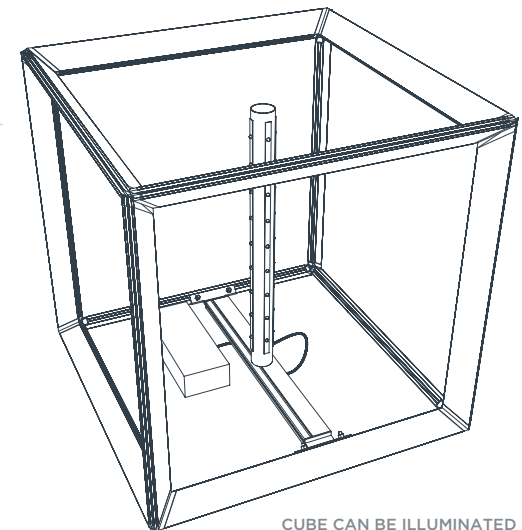

CUBE CAN BE ILLUMINATED  
WITH TUBE & LED TAPE

# RC040 cube ReFrame®

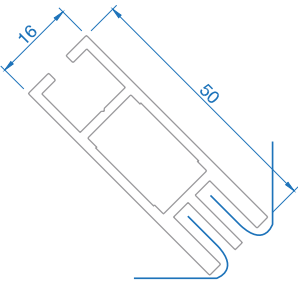

## applications

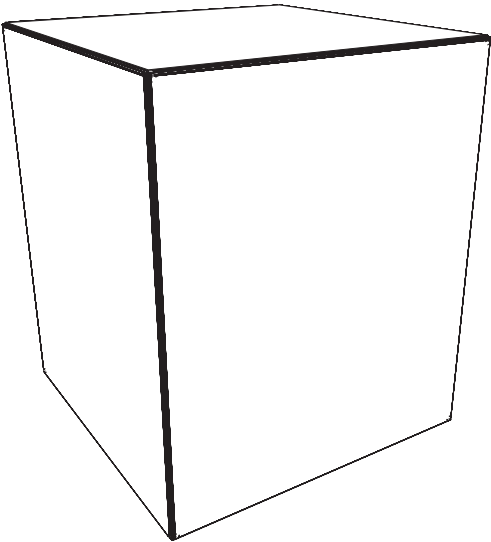
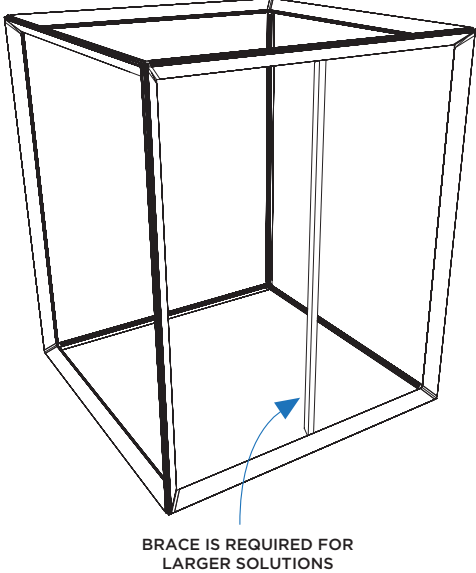
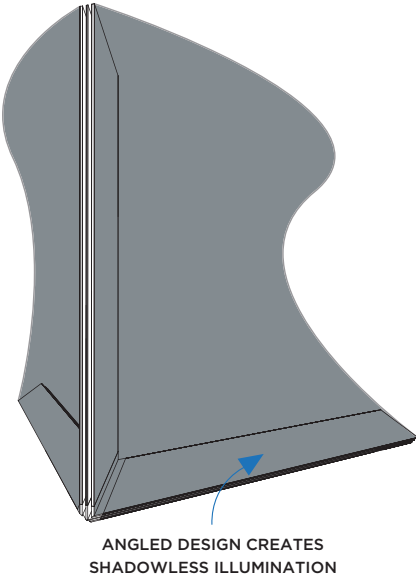
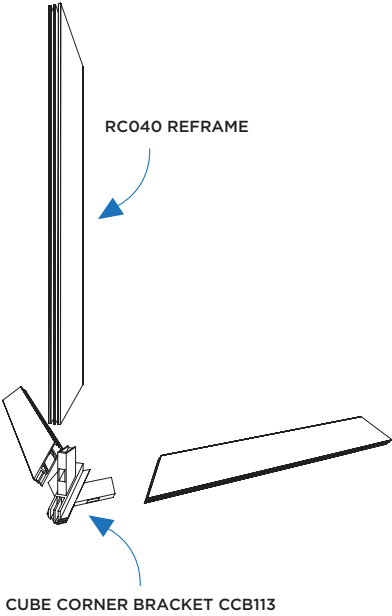

# RC051 cube ReFrame® - locking

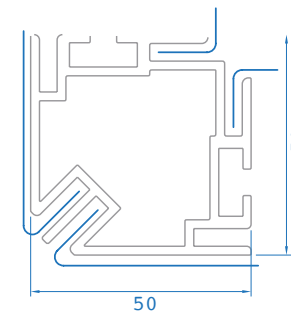

## applications

- For larger cubes
- Bracing uses twist locks
- Can be sectional using joiners

## components

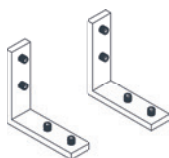

**CORNER BRACKET**  
CB009 (PACK OF 24)



**TWIST LOCK BRACING**  
BR001

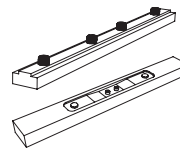

**JOINER**  
JNRSTA & Z977

## accessories



**RIGGING POINT**  
RP008 (M8 RATED)



**ILLUMINATION**  
P.O.A

EXTRUSION IS  
DOUBLE MITRED  
AND FIXED IN  
CORNERS WITH  
CB009 CORNER  
BRACKETS.

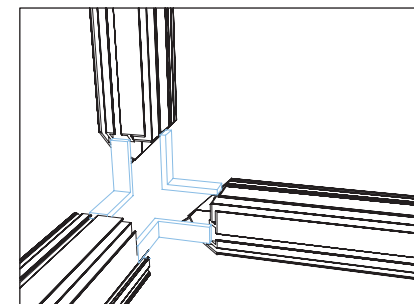



# RC060 cube ReFrame® - locking

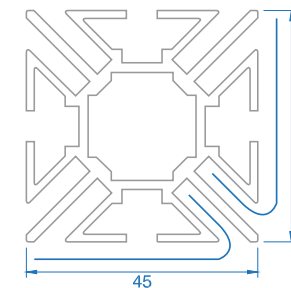

## applications

- Seamless structures
- Single sided or double sided
- Free standing or suspended

## components

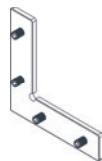

**CORNER BRACKET**  
CB005 (PACK OF 16)

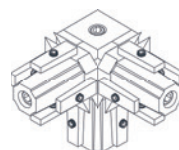

**CORNER BRACKET**  
CB22 (PACK OF 8)



**JOINER**  
JNR008



**TWIST LOCK BRACING**  
BR001

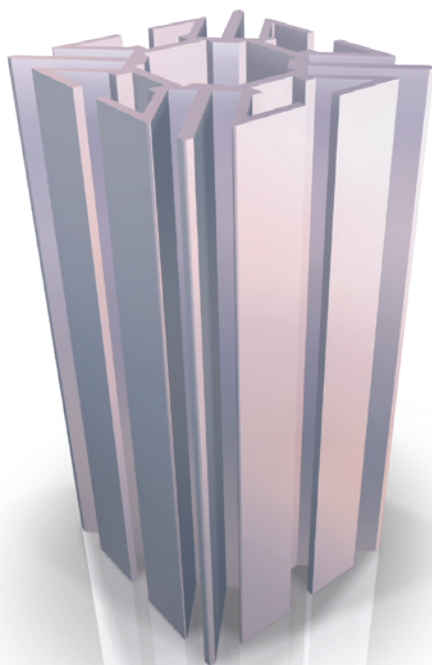

## accessories



**RIGGING POINT**  
RP008 (M8 RATED)



**ARM LIGHT**  
HAL001